

CS-PT1500 Pressure Transmitter



- Performance standard on and off highway engine and vehicle OEMs
- Rugged for heavy equipment and outdoor use
- Designed specifically for high volume applications
- Stainless steel wetted surfaces
- Medium to high pressures

DESCRIPTION

CS-PT1500 pressure transducer is based on Microfused sensor element. This model sets a new price performance standard for demanding engine and vehicle, and industrial applications. This transducer is suitable for measurement of liquid or gas pressure, even for difficult media such as contaminated water, steam and corrosive fluids.

The standard version includes a 1/4 NPT pipe thread allowing a leak-proof, all metal sealed system. There are no o-rings or organics exposed to the pressure media and the durability is excellent.

FEATURES

- Hermetic Pressure Ports
- Integral Electrical Connector
- Survives High Vibration
- $\pm 0.5\%$ Accuracy
- Water Resistant 1M Immersion

STANDARD RANGE (Gage)

0 to 100psi (7bar)
0 to 150psi (10bar)
0 to 200psi (14bar)
0 to 250psi (17.5bar)
0 to 300psi (21bar)
.....
0 to 700psi (49bar)

APPLICATIONS

- On and Off Highway Engines and Vehicles
- HVAC Refrigeration Controls
- Compressors
- Hydraulics
- Energy and Water Management

PERFORMANCE SPECIFICATIONS

- Overload Pressure: 250%F.S
- Burst Pressure: 500%F.S;
- Supply Voltage: 8 to 36Vdc, 5Vdc for ratiometric 0.5 to 4.5V or Non-ratiometric
- Output Signal: 4 to 20mA (2 wires), 0.5 to 4.5 (3 wires)
- Accuracy: $\pm 0.5\%$ FS (Normal Temperature) ;
- Working Temperature: -40°C to 125°C ;
- Insulate Resistance: $100\text{M}\Omega@100\text{VDC}$

ELECTRICAL CONNECTION

Packard

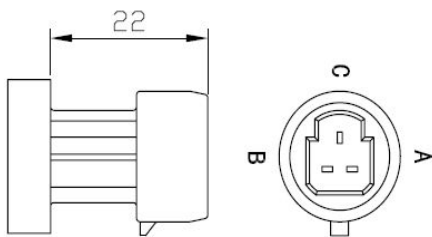

M12 × 1

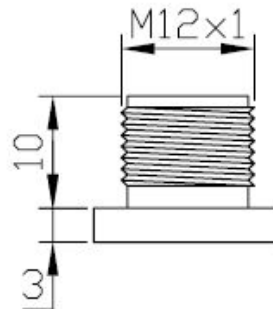

Cable

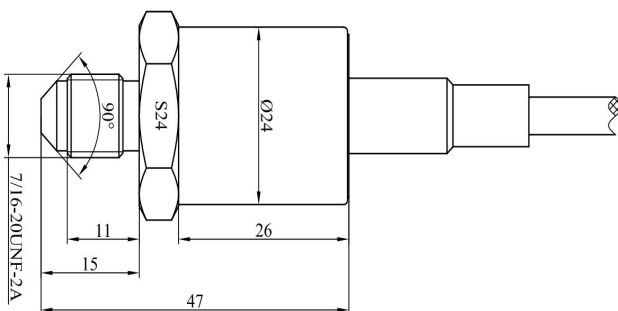

Din43650C



ORDERING INFORMATION

CS-PT1500	-A	-0/100PSI	-N	-H
Model	Output	Range	Pressure connection	Electrical connection
CS-PT1500	A:4 to 20mA B:0.5 to 4.5V C:0 to 5 V D:1 to 5V E:1 to 10V F: 0 to 10V ...	0 to 100psi 0 to 150psi 0 to 200psi 0 to 250psi 0 to 300psi 0 to 700psi	N: 1/4" NPT Male M:1/2" NPT Male G:1/4 BSP Male C:1/2 BSP Male U:7/16-20UNF-2A F:7/16-20UNF-2B ...	H: Din43650C D:Direct cable P: Packard M: M12×1

NOTE

For output 1 to 10Vdc and 0 to 10Vdc, power supply is 15 to 30Vdc
 Ratiometric output available upon requirement.